

### American Technical Fastening Systems

137 Schuylkill Avenue  
P.O. Box 486  
Hamburg, PA 19526  
Ph: 610.562.1277  
Fax: 610.562.8311  
www.amtechfs.com



Amtchfs dedicated to providing the metal-construction industry with fastening solutions in design, quality, value and service. Using rapid development and production techniques, Amtchfs offers a family of standard-duty and long-life systems for roof and wall applications, providing the right fastener for every construction challenge. The new MB/Delta Drill Screw uses advanced production techniques to produce a sharp, fast-drilling, milled-point fastener. Amtchfs also offers a complete range of structural bolts in all grades, as well as anchor bolts ready for immediate shipment.

### Applied Bolting Technology

1413 Rockingham Road  
Bellows Falls, VT 05101  
Ph: 800.552.1999 or 802.460.3100  
Fax: 802.460.3100  
www.appliedbolting.com



Squirter<sup>®</sup>-Twist bolts are twist-off bolts that DO NOT twist off! We removed the shear groove!

Squirter-Twist bolts look like TC bolts with its splined end, but they have a hex head. With their TC spline drive, installation is always one person from one side with a standard TC wrench. Unlike TC bolts, Squirter-Twist bolts do not break off at a certain torque. Heavy plies can be drawn-up without the end twisting off. No touch-up of the zinc coating at the break-off is needed. The hex head allows a spud to be placed on the bolt head if any problems develop or the bolt needs to be removed.

### Arc Machines, Inc.

10500 Orbital Way  
Pacoima, CA 91331  
Ph: 818.896.9556  
Fax: 818.890.3724  
www.arcmachines.com



Arc Machines, Inc., founded in 1976, manufactures automatic orbital tube, pipe and tube-to-tubesheet (GTAW) welding systems. Industries like semiconductor, food, dairy, biotechnology/pharmaceutical, aerospace, ship building and power generation use our line of equipment. Our tube-welding system is centered on the Model 207 Power Supply and line of Model 8 and 9 Series Weld Heads, which accommodates diameters from 0.093" (2.3 mm) to 7.5" (190.5 mm) O.D. Our newest tube welding head, the Model 4, is designed for high duty cycle welding of tube sizes up to 1" O.D.

### ARCON Welding LLC

2203 Northwood Drive, Building 10  
Salisbury, MD 21801  
Ph: 410.572.6000  
Fax: 410.572.6027  
www.arconweld.com



ARCON Welding manufactures "The Workhorse" welder line designed for the steel construction industry. Built to operate in harsh environments, these welding machines weigh around 80lbs, use SCR-type inverters for long life, and are housed in rugged, fiberglass-reinforced cases. The Workhorse product line includes the 300S Lift-start Stick/TIG welder, the MIGweld 300MS, the 700VDC-powered Ironhorse 300S, the TIGweld 300ST Capacitor-discharge arc-starter TIG welder, and the newly released 1200 Amp Studhorse that is capable of welding full-base 5/8" studs. Options include the Seahorse version for anti-corrosion protection and the Warhorse version where "dirty" voltage and spikes are extreme or generators are used for power. All Workhorse machines include an operator manual and a limited three-year warranty. Free tech support is available to Workhorse owners during the warranty period.

### Biach Industries, Inc.

75 Chestnut Street  
Cranford, New Jersey 07016  
Ph: 908.276.3110  
Fax: 908.276.0815  
www.biach.com



Since 1955, Biach has designed and manufactured bolt-tensioning systems for the construction, power generation, naval nuclear, petro-chemical and refinery industries. Biach engineers review customer data to develop the equipment design suitable to the working conditions, environment, bolting geometry, clearance concerns of adjacent components, time concerns and worker ease. Close attention is given to material and bearing stresses, load requirements and safety. Biach provides documentation services through its Biach Information Arts (BIA) division to gather and retain knowledge obtained over the years. BIA also produces complete training packages for training crews on the use of Biach systems. Biach's Field Service Team regularly supports commercial nuclear plants during outages and provides on-site training sessions on Biach equipment.

### ESAB Welding & Cutting Products

411 South Ebenezer Road  
Florence, SC 29501  
Ph: 800.ESAB.123  
Fax: 843.664.4258  
www.esabna.com

ESAB's PowerCut<sup>®</sup>-1250 Plasmarc<sup>™</sup> cutter delivers power and fast cutting speeds in an 86-lb package. You can make plasma cuts up to 1/4" (sever 1 1/2"). The composite fiberglass case is suitable for harsh environments like construction sites. The machine fits through manholes and tight spaces. A power-line conditioner allows it to operate with poor power lines. The PowerCut-1250 arrives ready-to-cut and includes the PT-32EH torch. ESAB's Coreshield<sup>®</sup> 6 and Coreshield<sup>®</sup> 8 are for bridge and structural fabrication in seismic areas. These self-shielded, flux-cored wires meet FEMA 353 Specification. Coreshield 6, an E70T-6 wire, is for horizontal applications. Coreshield 8, an E71T-8 wire, is for all-position welding.



### Fabsco Corp.

1745 West 124th Street  
Calumet Park, IL 60827  
Ph: 708.371.7500  
Fax: 708.371.7524  
www.fabscocorp.com

Fabsco Corp. is a 43-year-old company located in Calumet Park, IL, near Interstate 57. Fabsco manufactures anchor bolts: full and specialty-threaded rods in various material grades made from domestic steel, with threading capabilities from 3/8" diameter to 6" diameter. Fabsco also specializes in special packaging, vendor-managed inventory programs, and welding and rebar cage assemblies.

### Haydon Bolts, Inc.

Adams Avenue & Unity Street  
Philadelphia, PA 19124-3196  
Ph: 215.537.8700  
Fax: 215.537.5569  
www.haydonbolts.com

Haydon Bolts, Inc. offers the Tone M221 swivel head TC bolt wrench. The head moves 90 degrees to the left or right of the center axis in order to allow easy installation of TC bolts in hard-to-reach areas. Haydon sells, rents and services Tone TC bolt wrenches and the "Simple Torqon" electric wrench for hex bolts from 5/8" to 1 1/4" diameter. Haydon specializes in custom-manufactured anchor rods, tie-rod assemblies, u-bolts, eye bolts and j-bolts up to 4" diameter and up to 40' long, with either roll or cut threads. Haydon distributes of A325-1, A325-111, A490, A449 and A354-BD hex structural bolts and F1852-1 (A325) and A490 TC bolts.

## Welding and Bolting

### Inventory Sales Co.

9777 Reavis Road  
St. Louis, MO 63117  
Ph: 314.776.6200 or 800.272.7883  
Fax: 314.776.0054  
www.inventoriesales.com

Inventory Sales Company supplies: A325 TC bolts and hex-headed concrete anchors and shear connectors, anchor bolts, masonry anchors, deformed bar anchors, full line of fasteners, new, used and repairs of shear wrenches and all stud-welding equipment along with diesel generators. A fully equipped fabrication shop provides products such as shim plates, connection angles and embedment plates. ISC recently consolidated eight buildings in St. Louis into one 240,000-sq.-ft facility. Along with a fully staffed warehouse in Kansas City, ISC offers a central US location to handle the needs of erectors and fabricators.

### Jackson Products

801 Corporate Centre Drive, Suite 300  
St. Charles, MO 63304  
Ph: 636.300.2700  
Fax: 636.300.2810  
www.jacksonproducts.com

NexGen™ EQC® Auto-Darkening Welding Helmet offers 3N1™ technology for three modes of operation: weld, grind or torch; Intellisense™ technology detects welds less than 5 amps; SmartView™ LCD for fingertip control information; a two-year warranty; Clear View Light State keeps the lens down at all times to reduce eye strain and fatigue. The ShadowAire II™



Powered Air Purifying Respirator offers industrial-strength construction; flame-retardant, crush resistant hose; airflow standards exceed NIOSH by more than 25% and meets OSHA requirements; audible alarm for low battery and low airflow; adjustable belt with lumbar support; NiMH battery is 40% lighter than the NiCad battery; ShadowAire II PAPR w/ EQC NexGen and P3 Filters—two four-hour batteries and a fast charger, and an eight-hour battery and an overnight charger.

### LeJeune Bolt Company

3500 West Highway 13  
Burnsville, MN 55337  
Ph: 800.872.2658  
Fax: 952.890.3544  
www.lejeunebolt.com

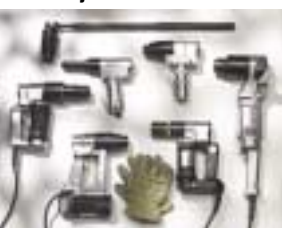

LeJeune Bolt Company supplies fasteners, weld studs, anchors and equipment to the construction, utility and OEM markets. Con-

struction and industrial fasteners are shipped to distributors and end users across North America and beyond. LeJeune has a company-wide commitment to timely delivery, quality products and exceptional service.

### The Lincoln Electric Company

22801 St. Clair Avenue  
Cleveland, OH 44117-1199  
Ph: 216.481.8100  
Fax: 216.486.1751  
www.lincolnelectric.com

The Air Vantage® 500 unit is a combination welder, generator and air compressor. It features a patent-pending direct gear-driven compressor with no belts or clutches to wear out. This compressor, rated at 60 CFM, 100 PSI



at 100 percent duty cycle, pumps out enough air for arc gouging, plasma cutting or almost any air tool. The unit comes standard with up to 20,000 watts of 3-phase 240V AC generator power and provides 12,000 watts continuous 1-phase AC generator power. It also delivers high output welding capability for stick, TIG, MIG and flux-cored welding. The unit also has a stainless steel roof, side panels and engine-access door.

### Lincoln Structural Bolt

25600 North 58th Court, Suite 2  
Lincoln, NE 68507  
Ph: 402.464.4433  
Fax: 402.464.4855  
www.lincbolt.com



This distributor of special and hard-to-find structural products currently carries: ASTM Bolt Standards A307, A325, A325M, A449 and A490; Grades A563 DH, DH3, C, C3 and A194 2H Nuts; F436, F844 and beveled washers; load indicating washers in Type 1, 3 and Squirreler®; A325 and A490 tension control bolts; structural metric products; fasteners in Grades 2, 5, and 8; expansion anchors; all thread studs and rods; coatings available in Plain Type 1 and Type 3; as well as mechanically and hot dip galvanized and zinc-plated. Full certifications and in-house rotational capacity tests are offered at no cost. Computerized lot numbers make tracking products easy.

### Lindapter North America, Inc.

3929 Varsity Drive  
Ann Arbor, MI 48108  
Ph: 888.724.2323  
Fax: 888.677.2339  
www.lindapterna.com



Lindapter North America Inc. specifies, designs and sells structural steel clamping systems. Lindapter connections do not require welding or drilling to existing or new primary steel, and eliminate problems like hot work permits, hazardous fumes, weakening of the primary steel and specialized labor costs. Monorails, cranes, hoists, pipe hangers, and utility connections all use Lindapter connections. Shims, clip washers or packing materials allow the clamps to adjust to any flange thickness; self-adjusting clamps are also available. Lindapter's Hollo-Bolt safely connects hollow steel sections in areas where access is available from only one side.

### Miller Electric Manufacturing Co.

P.O. Box 100  
Lithonia, GA 30058  
Ph: 800.4.A.MILLER (800.426.4553)  
Fax: 877.327.8132  
www.millerwelds.com



Through state-of-the-art technological advances, Miller Electric Mfg. Co. offers arc welding and cutting equipment for manufacturers. Miller's products cover a wide range of applications and processes, including gas-engine driven welding generators, such as the Bobcat™ 250 and Trailblazer® 302. Miller also carries diesel engine-driven welding generators (PRO 300 and Big Blue® 400 and 500); multiprocess and multioperator power sources (XMT® Series and XMT® 304 Rack); and plasma cutters (Spectrum® 2050).

### Multiquip, Inc.

18910 Wilmington Avenue  
Carson, CA 90746  
Ph: 800.421.1244  
Fax: 310.537.3927  
www.multiquip.com



Multiquip's new GAW-135H and GAW-180HE welder/generators are lightweight and compact power sources providing arc-welding characteristics. The GAW-135H is fueled by

a 5.5-horsepower Honda GX-200 gasoline engine and combines 135 amps of DC welding power with a 1.5kW AC output. With a dry weight of only 110 pounds (49½ kilograms), the GAW-135H is easy to carry around the job-site and in confined areas. Mounting it to service trucks or on high reach baskets is useful for utility welding applications. A 6-position dial, with settings of 40, 60, 80, 100, 115 and 135 amps, controls the current.

The GAW-180HE is a 180-amp welder/3kW generator combination engineered with a permanent magnet alternator, which reduces the GAW-180HE's weight to 242 pounds (110 kilograms). It has an 11-horsepower Honda GX-340 gasoline engine and is useful for service trucks, fence companies, utilities and general contractors. An adjustable current range from 50 to 180 amps, a 20-amp GFCI receptacle and 30-twist lock receptacle are provided. The GAW-180HE's new arc-force control feature lets the operator fine-tune DC currents during low voltage welding conditions. It also prevents electrodes from sticking during short arc length welding. Standard features on both models include wing nut connections for the welding cables, idle control low oil shutdown.

### Nelson Stud Welding Inc.

7900 West Ridge Road  
Elyria, OH 44035  
Ph: 440.329.0400  
Fax: 440.329.0492  
www.nelsonstudwelding.com



Nelson Stud Welding manufactures concrete anchors and deformed bar anchors for the pre-cast industry. For bridges and high-rise construction projects, Nelson (ISO/QS9000 certified) manufactures shear connectors in both standard and extra-long lengths. These shears tie bridge decks or floors to the structural-steel frame, resulting in a composite design. Many products go to safety-critical applications such as nuclear containment vessels, missile silos, fuel-rod storage facilities, and tunnels. Studs and materials are manufactured, tested and certified in compliance with AISC, AASHTO, AWS D1.1, D1.5 and other ISO and EN codes. Nelson also manufactures threaded studs, refractory anchors, collar studs and others for the electrical and mechanical trades.

### Nucor Fastener Division

6730 County Road #60  
P.O. Box 6100  
St. Joe, IN 46785  
Ph: 260.337.1626 or 800.955.6826  
Fax: 260.337.1726  
www.nucor-fastener.com



Nucor Fastener manufactures grades A325, A325 Type 3, A325-T, A325M, A490, and A490 Type 3 heavy hex bolts. The A325's are offered in several finishes including black (plain), hot-dip galvanized, and mechanical galvanized. Nucor offers an entire line of F1852 (A325) and A490 Tru-Tension™ assemblies. Standard hex structural bolts are offered in ½" through 1¼" diameters up to 10" in length. Nucor's Tru-Tension (TC) assemblies are available in ¾" through 1⅞" diameters. They stock structural nuts from ⅝" through 1¼", manufacture sizes ⅝" through 1" and offer ASTM grades C, C3, DH, DH3, and 2H. Nucor Fastener is ISO9000 and QS9000 certified. Containers are identified with lot numbers for traceability from raw material through processing and final inspection.

RGM Structural Steel Detailing, Inc.  
195 Industrial Drive  
P. O. Box 823  
Grand Island, NY 14072  
Ph: 716.773.5546  
Fax: 716.773.5583  
www.boltableanchorplate.com

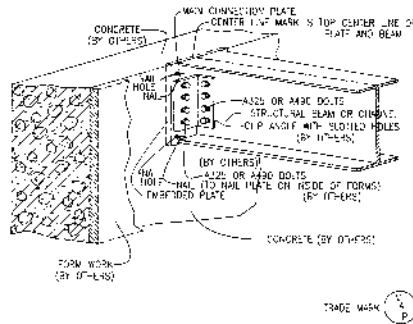

The VeRost Boltable Anchor Plate eliminates the dangerous and costly practice of field welding to a blind embed in concrete foundation walls. It provides connections for use on precast or tilt up panels and for structural steel from a W4 to W36 beam sizes. Beams are slotted for the normal adjustment allowed for concrete, as well as the outstanding legs of the connection angles. The General Contractor simply locates the Boltable Anchor Plate at the center top of the beam on the form before nailing the plate to the inside of the form. The reinforcing is not interrupted and easily passes the anchor plate studs. As with any connection, the Engineer of Record must approve this connection for the specified project.

### SidePlate Systems, Inc.

23422 Mill Creek Drive, Suite 215  
Laguna Hills, CA 92653  
Ph: 800.475.2077  
Fax: 949.305.6395  
www.sideplate.com



SidePlate™ steel moment frame connection technology responds to multi-hazard design challenges with the SureFramesystem: a structural framing system for wind, earthquake and progressive-collapse mitigation. It is compliant with all current U.S. government progressive collapse design standards and reduces overall steel fabrication and erection costs up to 15%. Blast mitigation attributes include discrete beam-to-beam continuity, connection resilience, connection redundancy, reliable inelastic connection, rotational capacity, concurrent reserve, and axial tension capacity. Services included with SidePlate connections include: technical assistance to Structural Engineer of Record in the optimization, modeling and dynamic analysis of the global lateral frames, analysis of identified "missing column" critical collapse scenarios, design of all steel frame SidePlate connections (including calcs, details and specifications), review and disposition of SidePlate™-related shop detail drawings, WPSs and PQRs, and visits to shop and field for quality assurance.

### Simpson Strong-Tie Anchor Systems

Simpson Strong-Tie Anchor Systems  
4120 Dublin Boulevard, Suite 400  
Dublin, CA 94568  
Ph: 925.560.9000  
Fax: 925.833.1496  
www.simpsonanchors.com

Simpson Strong-Tie Adhesive Anchors Systems provide anchoring products that meet all applications. The SET epoxy-anchoring system was the first adhesive to be listed for seismic applications by ICBO and offers high load values. Simpson's Acrylic-Tie adhesive is formulated to flow easily in cold weather and cure down to zero degrees Fahrenheit, so it can be installed in summer or winter. Both products have been tested in concrete and masonry and feature an array of code reports. The Titen HD anchor for concrete and masonry can anchor fixtures and base plates. It's a heavy-duty screw-type anchor available in ⅜"-¾" di-



## Welding and Bolting

ameters. The threads on the anchor undercut the base material as it is driven into the hole during installation, resulting in a vibration resistant, high-strength anchor. The length is stamped on the head of the product, and the patented thread design requires less installation torque. The anchor installs using standard drill bits and is removed easily.

### St. Louis Screw & Bolt

**6900 North Broadway  
St. Louis, MO 63147  
Ph: 800.237.7059  
Fax: 314.389.7510  
www.stlouisscrewbolt.com**



St. Louis Screw & Bolt (SLSB LLC) stocks structural bolts, TC Bolts, anchor bolts, and fabricated rod products. Many grades of domestically produced steels are available for special needs: diameters 1/2" through 4", and up to 40' in length. SLSB is a charter member of the Industrial Fastener Institute (IFI) and an associate member of the AISC and the NSBA. SLSB's in-house quality lab is A2LA certified and CALTRANS approved. SLSB ships to every state in the USA and any foreign country.

### Superbolt, Inc.

**P.O. Box 683  
Carnegie, PA 15106  
Ph: 412.279.1149  
Fax: 412.279.1185  
www.superbolt.com**

Superbolt manufacturers patented Multi-Jackbolt Tensioners, designed to solve bolting problems, save time and money, and eliminate unsafe, time-consuming bolting methods. Products require only hand tools for installation and removal. You don't need expensive tooling (hydraulic wrenches, stud heaters, etc.), and worker safety is greatly increased. Visit the web site to see Superbolt's different applications.

### TurnaSure LLC

**340 East Maple Avenue, Suite 305  
Langhorne, PA 19047  
Ph: 800.525.7193  
Fax: 215.750.6300  
www.turnasure.com**

TurnaSure manufactures Direct Tension Indicators (DTIs), Tension Indicating Washers (TIWs)



and Load Indicating Washers (LIWs) for use in the structural, automotive, off-highway, pressure vessel,

and anchorage industries. TurnaSure also produces special load-indicating washers for numerous special applications in which the engineer needs confirmation that prescribed bolt tension has been achieved in a tightened-fastener assembly. TurnaSure provides on-site product support free-of-charge.

### Tru-Weld

**460 Lake Road  
Medina, OH 44256  
Ph: 800.321.5588  
Fax: 330.725.0161  
www.tfpcorp.com**

Tru-Weld is a manufacturer of weld studs, stud-welding equipment, and stud-welding accessories. Tru-Welds manufactures a full line of weld studs, including concrete anchors, shear connectors, threaded studs, deformed bar and stud welding equipment. Tru-Weld manufactures stainless steel weld studs ranging in diameter from 1/4" to 1". Tru-Weld also manufactures a full line of stud welding equipment available for rent or purchase. The equipment line includes a TW1200, SC2000, and the newly added SCD3250.



### Vermont Fasteners Manufacturing

**P.O. Box 702  
Swanton, VT 05488  
Ph: 802.868.3663 or 450.658.8741  
Fax: 802.868.2089  
www.vfm.com**

Vermont Fasteners manufactures high-strength structural bolting products, including ASTM A325 structural bolts in Type 1, Type 3 weathering steel, mechanical, galvanized and hot-dip galvanized finishes. VFM produces ASTM A490 bolts and F1852 tension-control structural bolts on both A325 and A490 grades. Vermont also stocks nuts and washers, with products stocked at locations throughout North America.

